

DBL Series

The BEAST Evolution II™

Harsh Environment High Bay Light

Built For The
Toughest Environments



**the
BEAST**
evolution II



Proprietary (DOB)
Driver On Board
LED Modules are
field replaceable.



High Heat
Tolerant



Replaceable
LED Modules



Corrosion
Resistant



Chemical
Repellent



SOLAS RAY™ LIGHTING

5935 West 84th St. | Indianapolis, IN 46278 | 1-888-391-4822 | www.SolasRay.com

Cat. #	Type
Notes	

CERTIFICATIONS / RATINGS



CERTIFIED
UL 1598

IP66



KEY FEATURES AND BENEFITS

Our toughest industrial high bay LED light designed and tested to withstand the harshest conditions. Stands up to the punishment when other high bay lights fail.

- Die-cast aluminum alloy housing with built-in cooling fins.
- Ambient temperature rated at -70°C (-94°F) to 100°C (212°F).
- Proprietary DOB (Driver On Board) LED modules - **FIELD REPLACEABLE**
 - Reduces long term cost by avoiding fixture replacement.
- Flat tempered glass lens sealed with specialized silicone rubber gasket.
- Black corrosion resistant PVDF (Polyvinylidene Fluoride Finish).
 - Flame resistance holds up to high temperatures.
 - Chemical and abrasion resistance for harsh industrial conditions.
 - Provides UV stability and seal for hardware connections
- All hardware and cable gland are stainless steel.
- 30KV surge protection / zero inrush current spike.
- Multi-layered lens gasket and 12 lens clasp boots composed of silicone rubber.
- Pressure equalization vent to maintain atmospheric pressure inside the housing.
- 10' AWM style 4476 power cord is rated for 600v and 200°C.
- Power cord is silicone rubber sealed inside the cable gland.
- Cord accepting latching hook and safety cable standard.
- Stainless steel nameplate with QR code for product registration.
- 1,000 hour salt-fog test yielded no corrosion. [ASTM B117-19/ASTM D610-08(2019)]
- Trade Agreement Act (TAA) compliant.

SPECIFICATIONS

Voltage	120VAC / 277VAC / 347VAC / 480VAC
Wattage	210W / 350W (+/- 10%)
Color Temp	5000 Kelvin
Housing	PVDF coated aluminum alloy
Color	Black
Lens	Flat tempered glass lens
Efficacy	98.6 lm/W(350W) / 95 lm/W(210W)
CRI	>70

Beam Angle	150°
Cable Gland	Stainless steel
Power Cord	200°C rated, 10' length
Ambient Temperature	-70°C (-94°F) to 100°C (212°F)

LUMENS

210W	350W
20,706 lm	35,000 lm

WARRANTY

Ambient Temperature	Warranty Length
65° (149°F) Max Ambient Temp.	5 Year Limited Warranty
85° (185°F) Max Ambient Temp.	2 Year Limited Warranty
100°C (212°F) Max Ambient Temp.	1 Year Limited Warranty

PRODUCT ORDERING SELECTION

DBL	-	50	-	UBSS
Series <input checked="" type="checkbox"/> DBL	Watts <input type="checkbox"/> 210 - 210W <input type="checkbox"/> 350 - 350W	Kelvin <input checked="" type="checkbox"/> 50 - 5000K	Voltage <input type="checkbox"/> 120V - 120VAC <input type="checkbox"/> 277V - 277VAC <input type="checkbox"/> 347V - 347VAC <input type="checkbox"/> 480V - 480VAC	Mounting <input checked="" type="checkbox"/> UBSS - Universal Bracket - Stainless Steel (included)

DBL Series

The BEAST Evolution II™

SOLAS RAY™ LIGHTING

5935 West 84th St. | Indianapolis, IN 46278 | 1-888-391-4822 | www.SolasRay.com

DESIGN AND ENGINEERING DETAILS

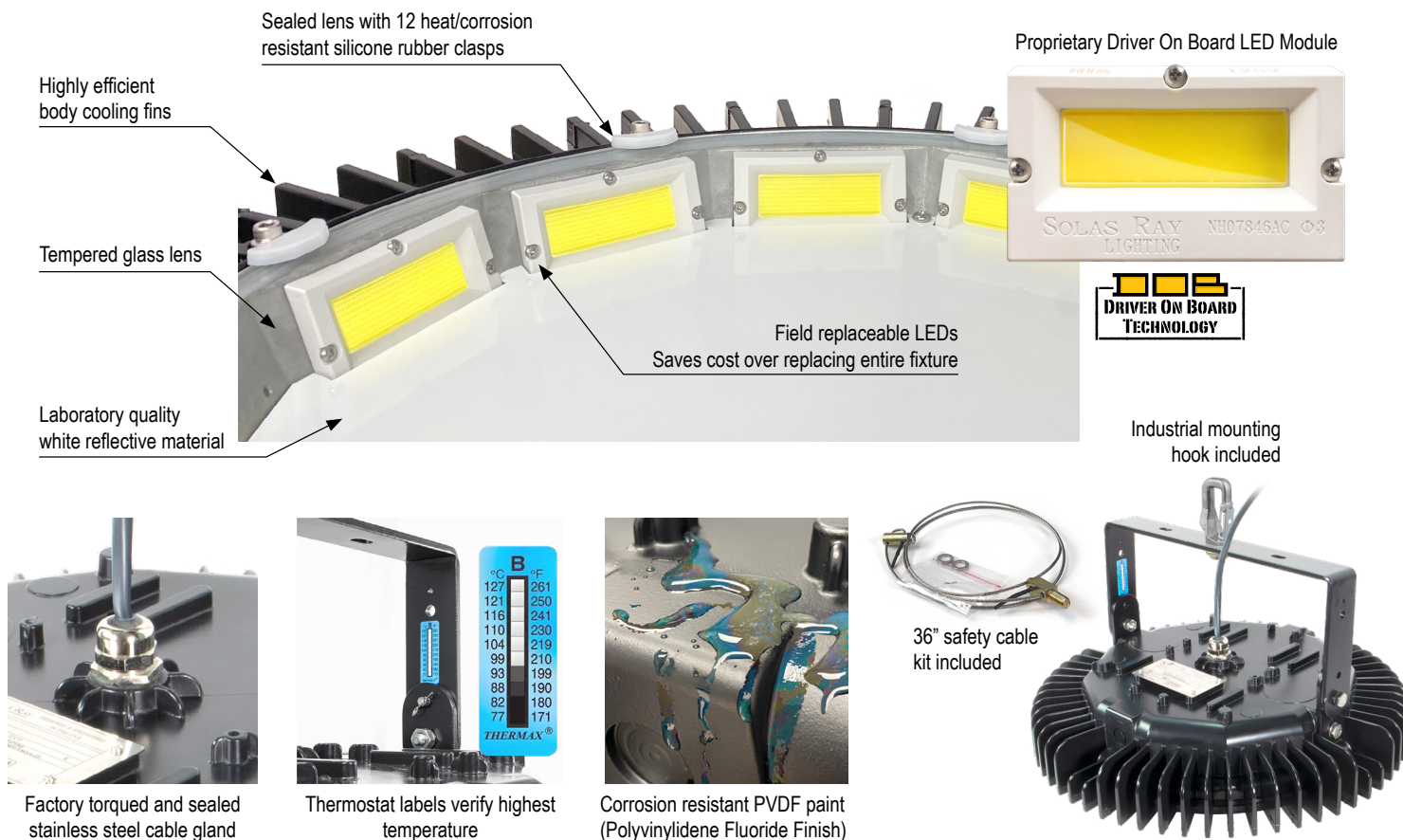

WEIGHTS AND DIMENSIONS

WEIGHT

32 lbs

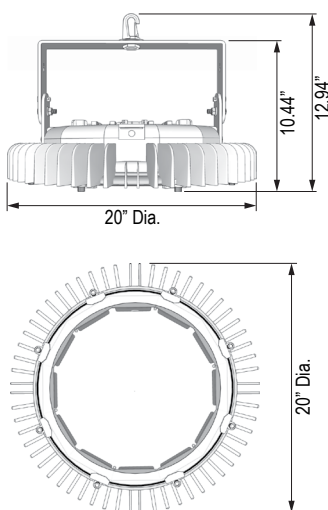

CHEMICAL AGENT RESISTANCE LIST

Acetamide 50%	Glykol	Salicylic acid
Acetic acid, aqueous solution 5%	Glycantin, aqueous solution 40%	Silicone oils
Acetic acid, aqueous solution 10%	Heating Oil	Soda lye, aqueous solution 50%
Ammonia solution 10%	Hydrochloric acid, aqueous solution 36%	Soda solution, aqueous solution 10%
Benzene	Hydrogen peroxide, aqueous solution 30%	Sodium bisulphate, aqueous solution 10%
Benzine	Ink	Sodium chloride, aqueous solution 10%
Boric acid, aqueous solution 10%	Isopropanol	Sodium nitrate, aqueous solution 10%
Butyl acetate	Lactic acid, aqueous solution 90%	Sodium thiosulphate 10%
Calcium chloride solution 10%	Linseed oil	Sulphur dioxide
Carbon trachloride	Methanol	Sulphuric acid, aqueous solution 2%
Chloroform	Mythylene chloride	Tartaric acid
Citric acid, aqueous solution 10%	Milk	Tetrahydrofurane
Cupric sulphate 10%	Nitric acid, aqueous solution 2%	Toluene
Cyclohexane	Oxalic acid, aqueous solution 10%	Transformer oil
Diesel Oil	Ozone	Trichlorethylene
Dioxane	Parafin oil	Vaseline
Edible fats and oils	Perchlorethylene	Wax, molten
Ethanol 96%	Petroleum	Winer, Brandy
Ethyl acetate	Phenol, aqueous solution	Xylene
Ethyl ether	Phosphoric acid concentrate	Zinc chloride, aqueous solution 10%
Formaldehyde, aqueous solution 30%	Potassium dichromate, aqueous solution 10%	
Formic acid, aqueous solution 10%	Propanol	
Glycerine	Pyridine	