

SQUARE BOLLARDS with Flat Top

BQSQ

120 - 277vAC



Type III
Type V

Square
Louvers

Cone
Reflector

Cat. #	Type
Notes	

DESIGNATIONS



IP67



KEY FEATURES AND BENEFITS

These durable, square flat topped LED Bollards are designed and produced to provide uniform ambient lighting while accenting any landscape or location.

This square bollard provides low glare to a wide area and compared to HID bollard lighting, is truly cost-effective pathway lighting for retail centers, industrial parks, schools and universities, public transit and airports, office buildings and medical facilities.

Custom heights are available upon request.

SPECIFICATIONS

Housing:

Extruded Aluminum Housing with Flush Mounting Base & Vandal-Resistant Screws, Flat Top, Internal Ballast Tray for Easy Maintenance.

Listing & Ratings:

CSA: Listed for Wet Locations, ANSI/UL 1598, 8750, IP65 Sealed LED Compartment.

Finish:

Textured Powdercoat Over Chromate Conversion Coating. Custom Colors Available Upon Request.

Styles:

IES Type III or V Clear Prismatic Borosilicate Glass Refractor, Specially Designed Aluminum Cone Reflector or Internal Louvers

Lens:

Clear Polycarbonate Vandal-Resistant Lens

Mounting Options:

Mounting Kit with 8-inch Anchor Bolts, Included.

LED:

Aluminum Boards

Wattage:

Array: 14.5w, System: 17w (70w HID Equivalent)

Driver:

Electronic Driver, 120-277V, 50/60Hz; 347V, 50/60Hz; Dimmable Driver

5-Year Warranty for -40°C to +40°C Environment.

Universal Retrofit Base Kit



Item	Wattage	Voltage	Kelvin
BQSQ-015-30-X-U	15w	120-277v	3000K
BQSQ-015-40-X-U	15w	120-277v	4000K
BQSQ-015-50-X-U	15w	120-277v	5000K
BQSQ-015-AM-X-U	15w	120-277v	AMBER

Note: Includes Mounting kit with 8" anchor bolts)

PRODUCT ORDERING SELECTION

BQSQ		015	U				
Series BQSQ	Optics <input type="checkbox"/> C - Type III <input type="checkbox"/> F - Wide Spread	Wattage <input type="checkbox"/> 015 - 15 Watts	Voltage <input type="checkbox"/> U - 120-277vAC	Kelvin <input type="checkbox"/> 30 - 3000K <input type="checkbox"/> 40 - 4000K <input type="checkbox"/> 50 - 5000K <input type="checkbox"/> AM - Amber	Lens <input type="checkbox"/> III - Type III <input type="checkbox"/> V - Type V <input type="checkbox"/> VSL - Type V Square <input type="checkbox"/> VCR - Type V Cone	Body Color <input type="checkbox"/> Z - Bronze (std) <input type="checkbox"/> B - Black <input type="checkbox"/> C - Custom	Options / Accessories <input type="checkbox"/> SF - Single Fuse <input type="checkbox"/> DF - Double Fuse <input type="checkbox"/> SP - Surge Protection <input type="checkbox"/> GF1 - GFCI Outlet / 15A / 120vAC <input type="checkbox"/> BU - Battery Backup, 90 Minutes <input type="checkbox"/> BRK - Universal Retrofit Base Kit



SQUARE BOLLARDS with Flat Top

BQSQ

120 - 277VAC

MOUNTING



Universal Retrofit Base Kit
Fits all 7" and 4" bollards

#BRRK



BOLAN

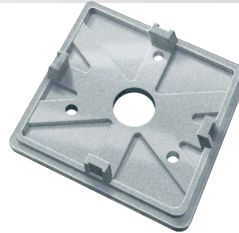

BOSBASE



3EBL120277



BOLPCS

Order Separately, Field Installed

- BOLAN4 = Mounting Kit, Includes Bracket & Three (3) 4" Anchor Bolts
- BOLAN8 = Mounting Kit, Includes Bracket & Three (3) 8" Anchor Bolts
- BOLAN12 = Mounting Kit, Includes Bracket & Three (3) 12" Anchor Bolts
- BOLAN15 = Mounting Kit, Includes Bracket & Three (3) 15" Anchor Bolts
- BOLPCS = Replacement Square Polycarbonate Vandal-Resistant Lens
- 3EBL120277 = Battery Backup, Provides 90 Minutes of Backup Power.
- BOSBASE* = Die Cast Base Plate with Powdercoat Finish Over a Chromate Conversion Coating.

*Specify Color: Z=Bronze, B=Black, W=White, G=Gray, C=Custom (Consult Factory)

PHOTOMETRIC OUTPUT

Type III

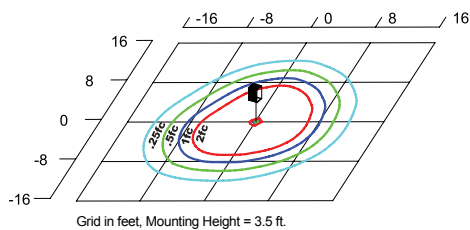

Type V

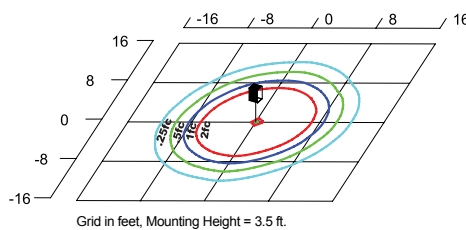

Cone Reflector

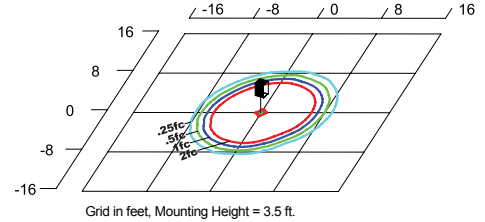

DIMENSIONS

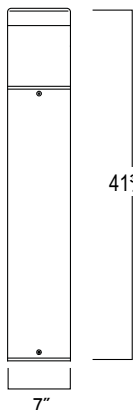

41 5/8" Custom Heights Available Upon Request.

PRODUCT DESIGNATIONS

