



SD



ST



SH



SHL

Challenger Linear Light System

by



COMMERCIAL ELECTRONICS

Challenger



Key Features

- Precision Angled LED Arrays establish exact light distribution.
- Diffused Polycarbonate Lenses eliminate glare and hot spots.
- Extruded Aluminum Housing, Sealed and Lead-Free.
- Low Profile Fixture Body expands mounting possibilities.
- Color-Coded End Caps for immediate fixture identification

Unique Benefits

- Clean No-Glare Lighting
- Quick Visual Identification
- No 60 Cycle Hum
- Lightweight and Easy to Install
- Resists Dust & Insect Intrusion
- No Wasted Light Distribution



These High-End Linear Lights Offer the Performance Solution to Commodity Linears.

Challenger SD

Length	Power (w)	Light Output (lm)
4 ft.	42w	5,200 lm
8 ft.	84w	10,400 lm

Challenger ST

Length	Power (w)	Light Output (lm)
4 ft.	27w	3,300 lm
8 ft.	56w	6,760 lm

Challenger SH

Length	Power (w)	Light Output (lm)
4 ft.	120w	15,600 lm
8 ft.	145w	17,835 lm

Challenger SHL

Length	Power (w)	Light Output (lm)
4 ft.	74w	8,800 lm
8 ft.	100w	12,000 lm

Installation At-A-Glance

This light is designed to snap open and closed for easy access. Ships complete with pre-wired Wagos™ that allow using the fixture to “self-run” the power.

When fixture is snapped open, there is a single Quick-Connect from LED to Driver.

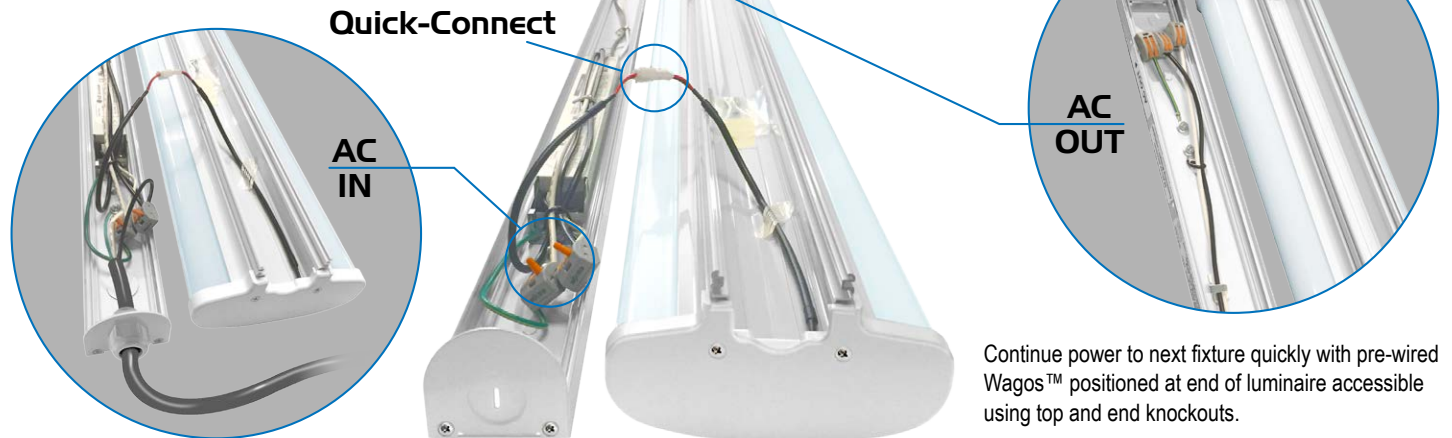

Dimensions & Weights

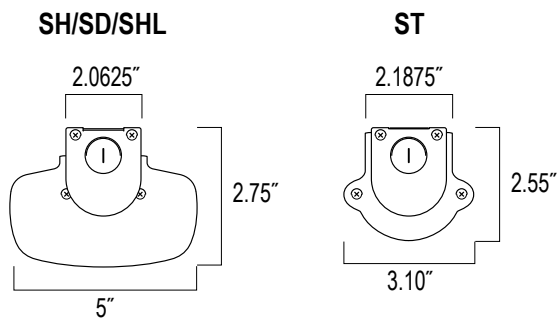

WEIGHT RANGES:

4 ft. 5.73 lbs.
8 ft. 11.6 lbs.

WEIGHT RANGES:

4 ft. 3.09 lbs.
8 ft. 5.29 lbs.

Profile Views

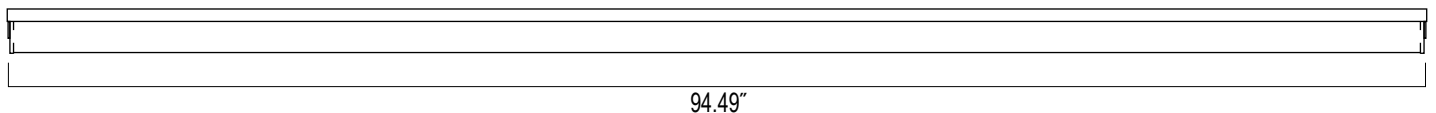
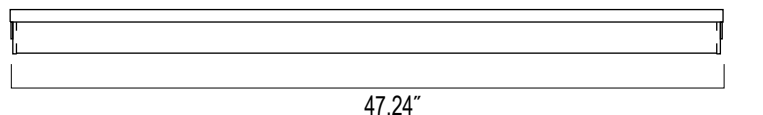

Options

Sensor Connect: Wireless lighting control ready (ZigBee®)
Sensor-embedded (occupancy sensing & daylight harvesting)
models are available for additional energy savings
also allows grouping and scheduling.



Maintain complete control of your lighting environment with a free online Sensor Connect mobile app.

Mounting

All fixtures have a knockout grouping less than 24" apart. Mounting can be surface mount, chain, cable or all-thread.



Knockouts

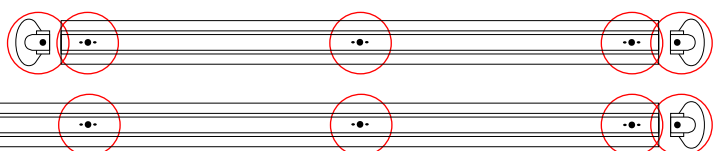

COMMERCIAL LED LIGHT FIXTURES



Catalog Number	Type
Notes:	

Technical Specifications

AOT Ambient Operating Temperature of 14°F to +104°F

Product	SH	SD	SHL	ST
Dimensions	4 feet / 8 feet	4 feet / 8 feet	4 feet / 8 feet	4 feet / 8 feet
Housing	Aluminum Alloy	Aluminum Alloy	Aluminum Alloy	Aluminum Alloy
Color	White / Brown Cap	White / White Cap	White / Black Cap	White / White Cap
Lens	Polycarbonate	Polycarbonate	Polycarbonate	Polycarbonate
Wattage	120w / 145w	42w / 84w	74w / 100w	27w / 56w
Voltage	120-277vAC	120-277vAC	120-277vAC	120-277vAC
Lumen Output	15,600 / 17,835	5,200 / 10,400	8,880 / 12,000	3,300 / 6,760
Efficacy	130 lm/w / 123 lm/w	124 lm/w	120 lm/w	121 lm/w
L80 Lifetime	50,000 hr. at L ₈₀	50,000 hr. at L ₈₀	50,000 hr. at L ₈₀	50,000 hr. at L ₈₀
CRI	≥80	≥80	≥80	≥80
Beam Angles	275°	135°	180°	120°
Color Temperature	5000K	5000K	5000K	5000K
Operating Temperature	14°F to +104°F	14°F to +104°F	14°F to +104°F	14°F to +104°F
Light Distribution				

5-Year Limited Liability Warranty.

Product Ordering



SH Series 4'
□ SH4B3432NU50

SH series 8'
□ SH8B2465NU50



SD series 4'
□ SD4B4808DU50

SD series 8'
□ SD8B4815NU50



SHL series 4'
□ SHL4B2432NU50

SHL series 8'
□ SHL8B3432NU50



ST series 4'
□ ST4B3208DU50

ST series 8'
□ ST8B3215DU50

